

[Support Package]

ID	TS-00004	Created	March. 15, 2006
		Updated	Dec. 22th, 2006
Category	Hardware	Sub Category	Installation
Product	CAM-6500/6600		
Purpose	CAM-6500, CAM-6600 accessory selection Guide		
Support URL	http://www.acti.com/support		
Tech Support	Customer.service@acti.com		
MSN Messenger ID	Customer.service@acti.com		

[Support Package]

CAM-6500, CAM-6600 accessory selection Guide

This support package tells you

- A. What accessories are available to CAM-6500, CAM-6600?
- B. How to select each accessory

Table of contents:

<i>Chapter1: CAM-6500, CAM-6600 accessory list.....</i>	<i>2</i>
<i>Chapter2: Select mount</i>	<i>3</i>
<i>Chapter3: Select installation type.....</i>	<i>3</i>
<i>2-1. CAM-6500 Indoor Type1 selection flow</i>	<i>5</i>
<i>2-2. CAM-6500 Indoor Type2 selection flow</i>	<i>6</i>
<i>2-5. CAM-6600 Outdoor Type1 selection flow:.....</i>	<i>7</i>
<i>2-6 CAM-6600 Outdoor Type2 selection flow:.....</i>	<i>8</i>
<i>Chapter3: Select dome cover</i>	<i>9</i>
<i>3-1. Non-Vandal / Vandal:</i>	<i>9</i>
<i>3-2. Smoke Cover / Clear Cover:</i>	<i>9</i>

Chapter1: CAM-6500, CAM-6600 accessory list

You can check what accessories you need, and what accessories are contained in the standard package of CAM-6500 and CAM-6600 series from the table below.

Model number	Accessory	Do I need it?	Standard package offering
CAM-6500 Series	Mount	V	N/A
	Housing	V	Non-vandal
	Dome cover	V	Clear, Non-vandal
CAM-6600 Series	Mount	V	N/A
	Housing	V	Vandal + Sunshield
	Dome cover	V	Clear, Non-Vandal
	Power Box	Optional	N/A

Then we can select the respective accessory according to the selection flow below.

[Support Package]

Chapter2: Select mount

Below table shows what mount application CAM-6500 and CAM-6600 support.

Camera Model number	Indoor	Outdoor
CAM-6500 Series	OK	N/A
CAM-6600 Series	OK (same as outdoor)	OK

Then refer to the selection flow below to select the mount for your customer.

- Step1: Select Camera model number
- Step2: Select Mount Type
- Step3: Get your Mount model number

Chapter3: Select installation type

For different customer, you might need different installation type.

Type1. Only basic bracket and customer does all the cabling and waterproof

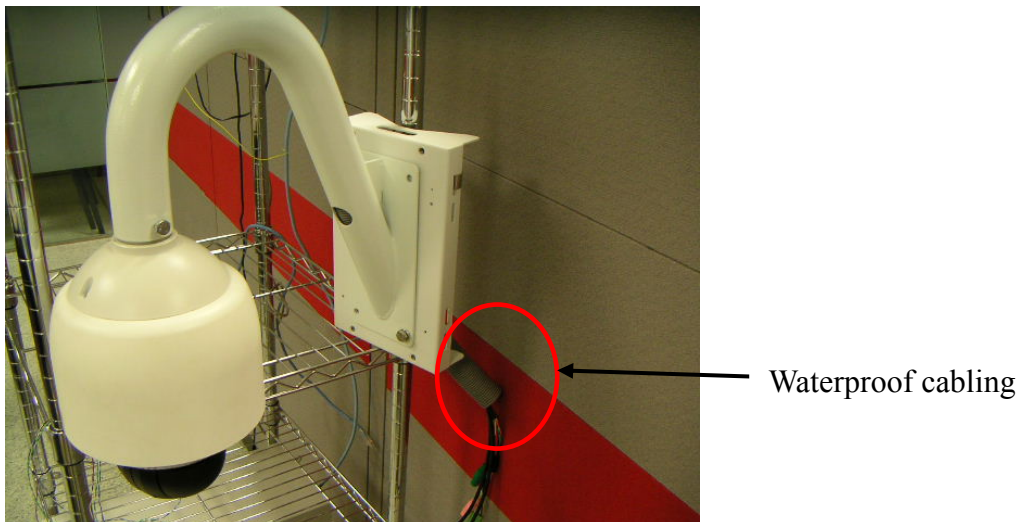

[Support Package]

Type2. Advanced brackets with waterproof power box

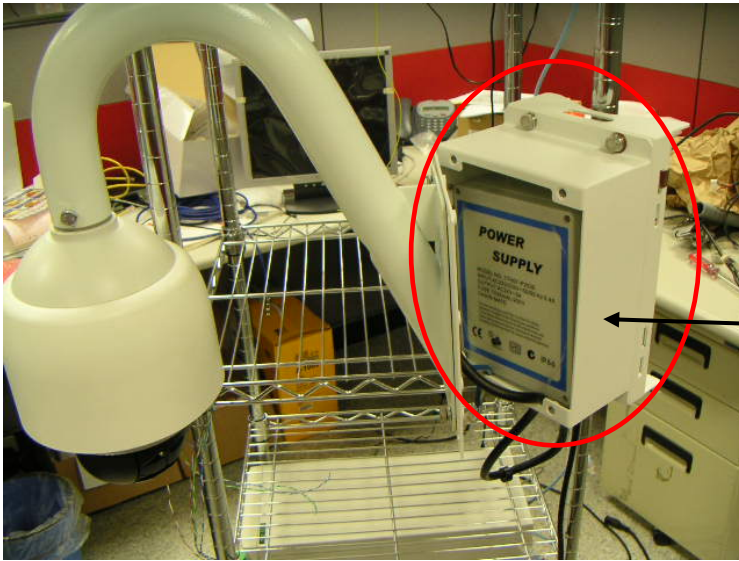

Mount BOX +
Waterproof power box

[Support Package]

2-1. CAM-6500 Indoor Type1 selection flow

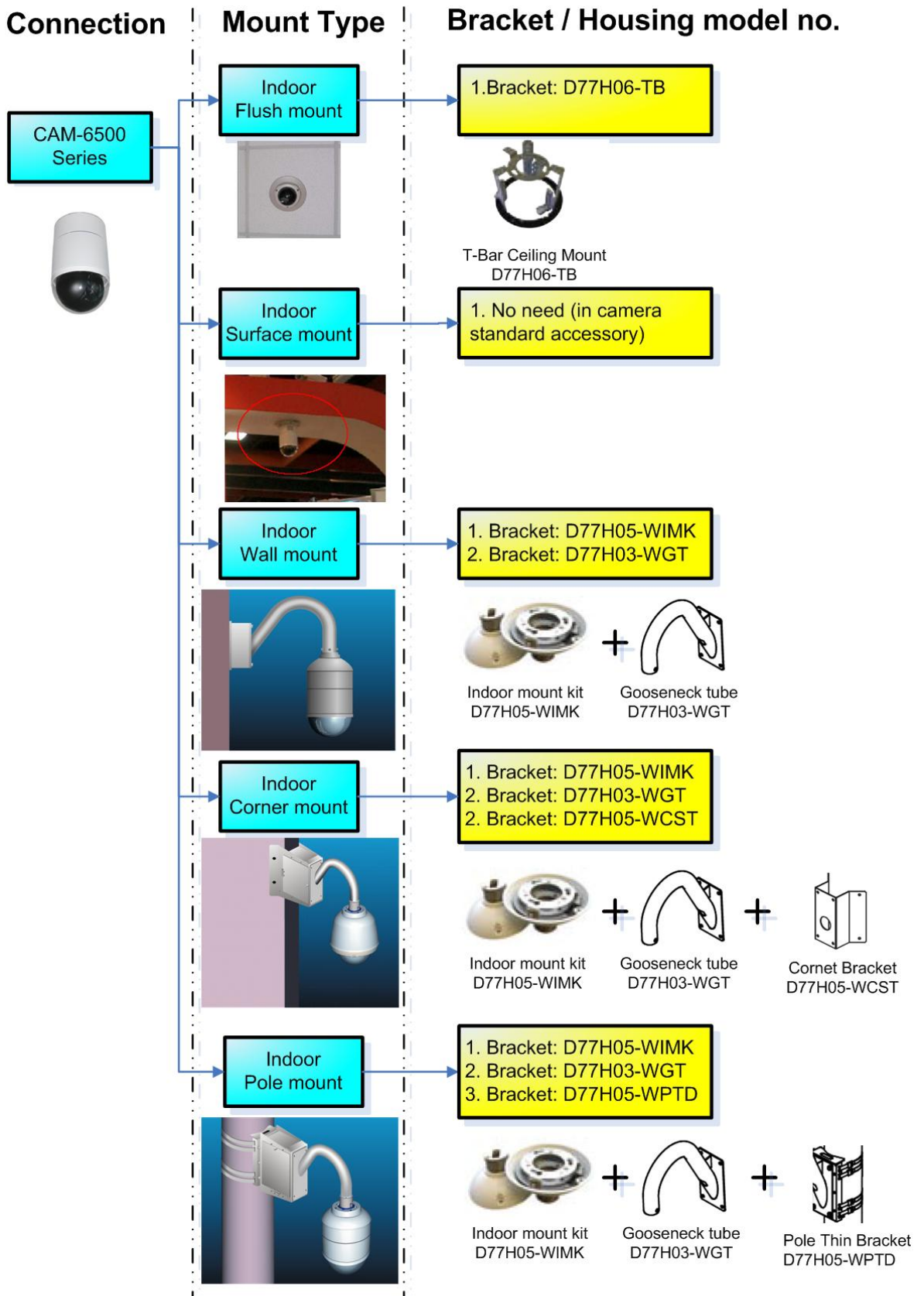

[Support Package]

2-2. CAM-6500 Indoor Type2 selection flow

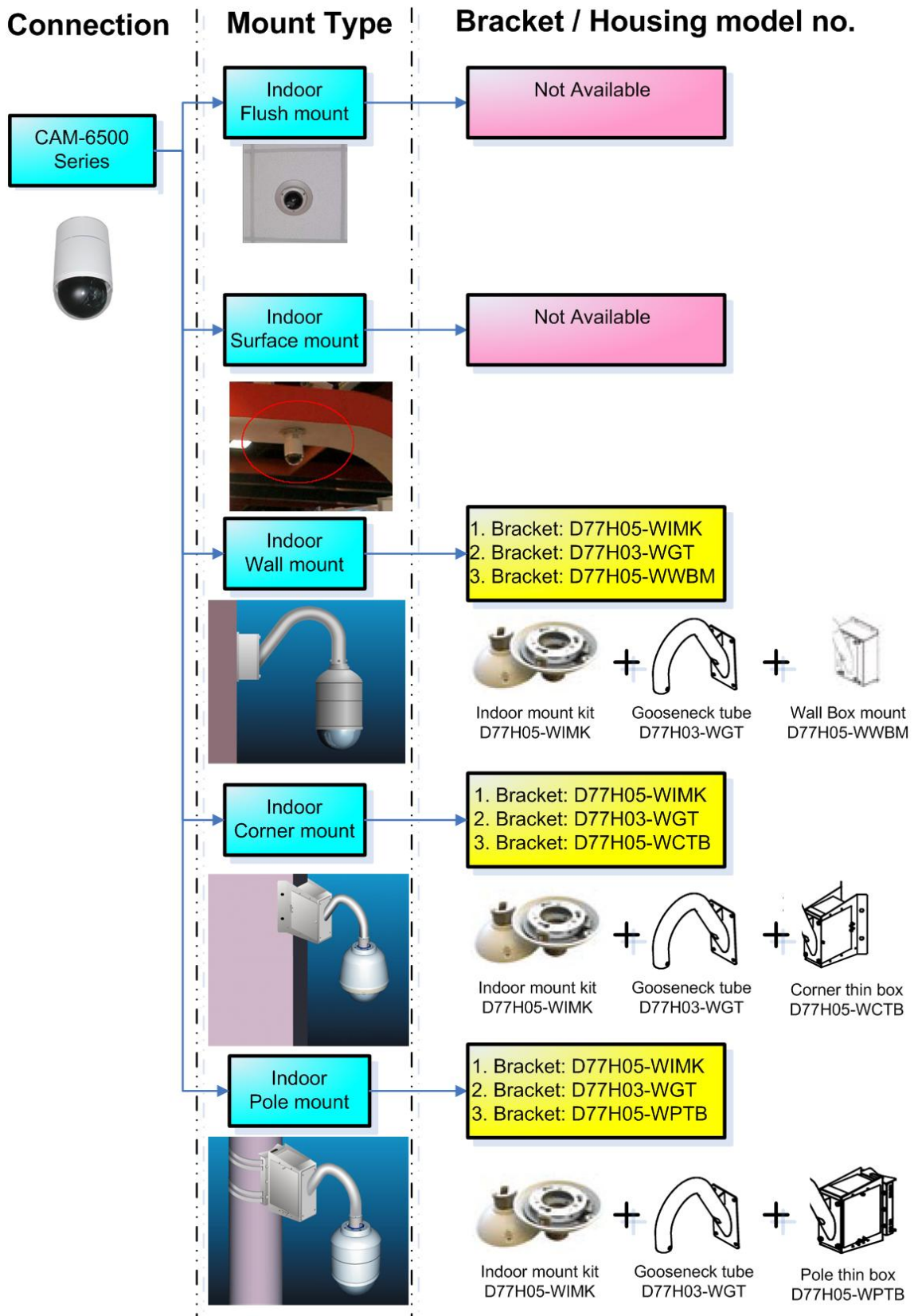

[Support Package]

2-5. CAM-6600 Outdoor Type1 selection flow:

Step1: Select Camera model

Step2: Select Mount Type

Step3: Get Bracket / Housing model number

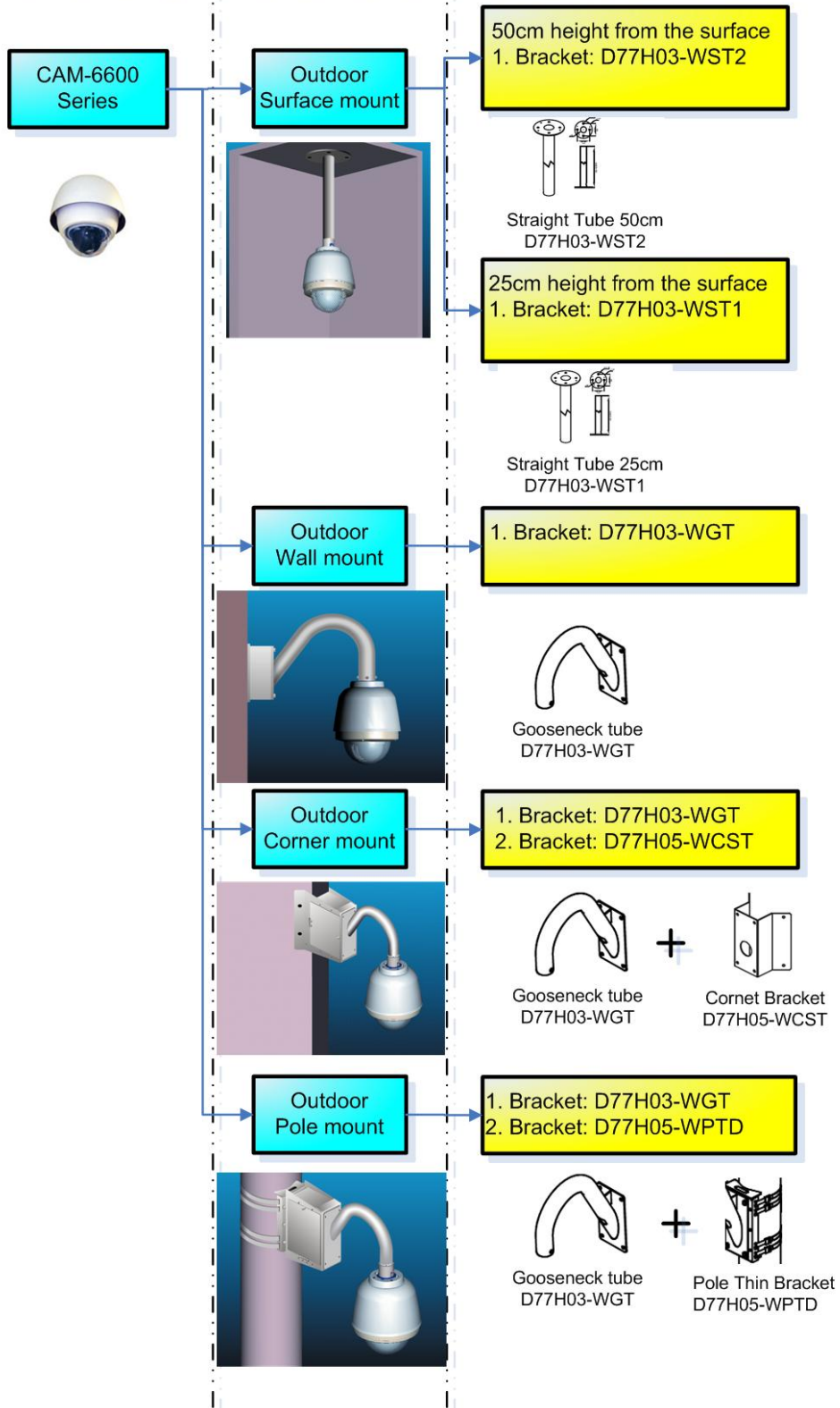

[Support Package]

2-6 CAM-6600 Outdoor Type2 selection flow:

Step1: Select Camera model **Step2: Select Mount Type** **Step3: Get Bracket / Housing model number**

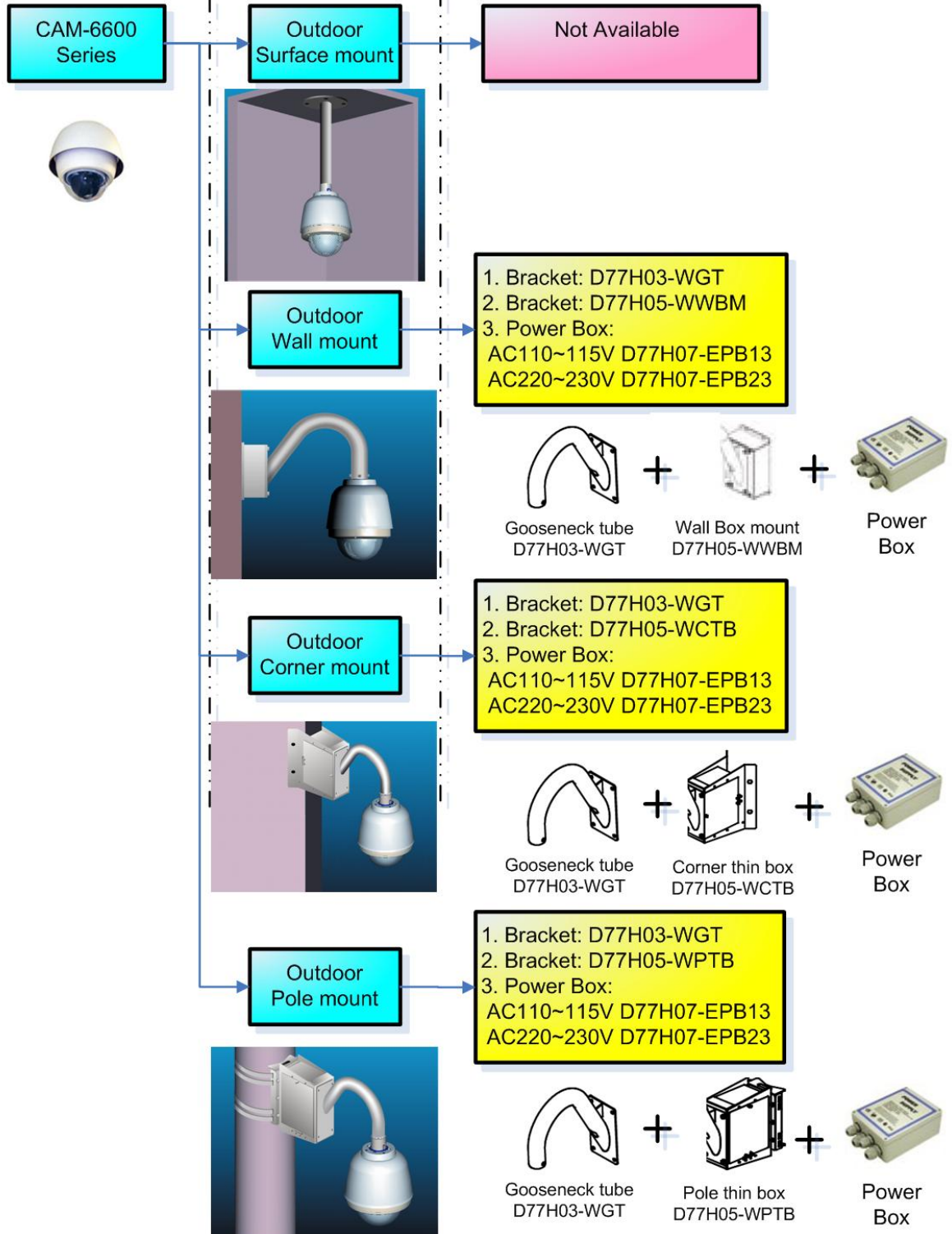

[Support Package]

Chapter3: Select dome cover

The below table shows what dome cover we provide in the standard package. If you would like to change the dome cover, you need to buy an additional one, instead of replacing the dome cover in the standard package.

If you need an additional dome cover, you could choose from the following two aspects.



3-1. Non-Vandal / Vandal:

A vandal cover can provide more protection against vandalism compared to a non-vandal cover. If you have concern about vandalism, please choose the vandal cover.

3-2. Smoke Cover / Clear Cover:

Smoke cover let others be unaware of where the speed dome is shooting. The camera performance is likely to be the same using either smoke or transparent cover. If you don't want others know where you are shooting, then choose the smoke cover.

Non-Vandal / Vandal	Non-Vandal Cover		Vandal Cover	
	Smoke	Transparent	Smoke	Transparent
CAM-6500 Series	61-PDH700108A1(5.4")	61-PDH700106A1(5.4")	N/A	61-PDH700109A1 (5.4")
CAM-6600 Series	69-PDH8111CS1	69-PDH8111CT1	N/A	69-PDH8111CV1

	Provided in standard package
	Need to place an additional order
	Not available